

Italian Designed. Australian at heart

S1218P

Nickel Slimline Pull Out Mixer



Features

- Solid brass construction
- Pull out hose
- Nickel finish
- Flicking mixer hot & cold water flow
- 360 degree swivel spout
- 35mm Ceramic cartridge
- 10 Year warranty
- 1 Year labour warranty
- WELS Star rating: 6 Star, 4L/M

Accessories Included

- Set of mounting accessories

Power Specifications

Pressure rating: Maximum operating pressure 1000kPa. Note: For best performance and longer life we recommend 300-800kPa

Temperature rating: Maximum hot temperature 80°C, minimum 5°C

Product Dimensions

445mmH x 220mmW

Installation Information

A suitably qualified plumber is required for installation. It is suitable that this tap is installed directly through a solid bench top or a top mounted sink.

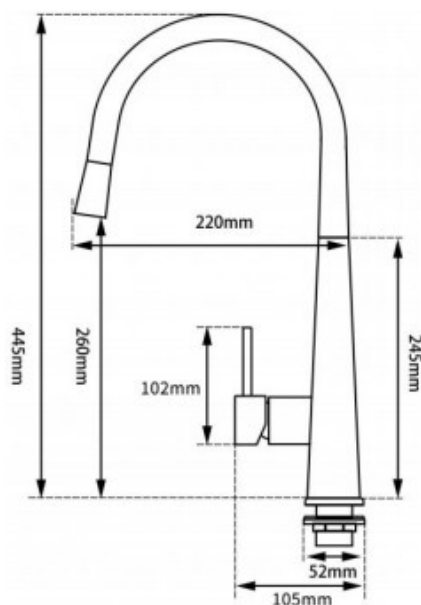

Please note:

Dimensions and specifications are a guide only refer to the instruction manual for full instructions. Every effort has been made to ensure this information is correct. However, due to product improvement Daniela Appliances reserves the right to make changes to products without prior notice.

IN HOUSE **2** YEARS WARRANTY